

Appendix 2:

VILLAGE RESERVES TITLES
& GAZETTE INFORMATION

APPENDIX 2A: LIST OF RESERVES TITLES

Castle Hill Village was subdivided from Rural Section 41208, 23.7520 ha, belonging to Castle Hill Run Ltd. The subdivision is shown on DP45980.

This subdivision established the original reserves within the village, which are contained within the following titles:

<i>Title ref.</i>	<i>Lot numbers (D.P. 45980)</i>	<i>hectare</i>	<i>purpose</i>
39C/12	1002, 1003 & 1004	2.9953	Recreation Reserve
39C/13	1005	0.0823	Local Purpose (utility) Reserve
39C/14	1006, 1007, 1008, 1009, 1010, 1011, 1012, 1013, 1014, 1015, 1016, 1017, 1018, 1019, 1020, 1021, 1022, 1023, 1024 & 1025 (20 lots)	0.0024	Local Purpose (utility) Reserves
39C/15	1032, 1033, 1034, 1035, 1036, 1037 & 1038 (7 lots)	0.0007	Local Purpose (utility) Reserves
39C/56	1026, 1027, 1028, 1029, 1030, 1031 & 1040 (7 lots)	0.0007	Local Purpose (Utility) Reserve

Copies of the above titles are included as Appendices 2B – 2D herein.

APPENDIX 2B: ORIGINAL RESERVES

Valuation Roll 242.7/160 pt

References
 Prior C/T 23A/343
 Transfer No.
 N/C. Order No. A130359/1

Land and Deeds 69



No. 39C/12

CERTIFICATE OF TITLE UNDER LAND TRANSFER ACT

This Certificate dated the 23rd day of August one thousand nine hundred and ninety-four under the seal of the District Land Registrar of the Land Registration District of CANTERBURY

WITNESSETH that THE SELWYN DISTRICT COUNCIL for a Recreation Reserve Subject to the Reserves Act 1977 ---

is seized of an estate in fee-simple (subject to such reservations, restrictions, encumbrances, liens, and interests as are notified by memorial underwritten or endorsed hereon) in the land hereinafter described, delineated with bold black lines on the plan hereon, be the several admeasurements a little more or less, that is to say: All that parcel of land containing 2.9553 hectares or thereabouts being Lots 1002, 1003 and 1004 Deposited Plan 45980 ---

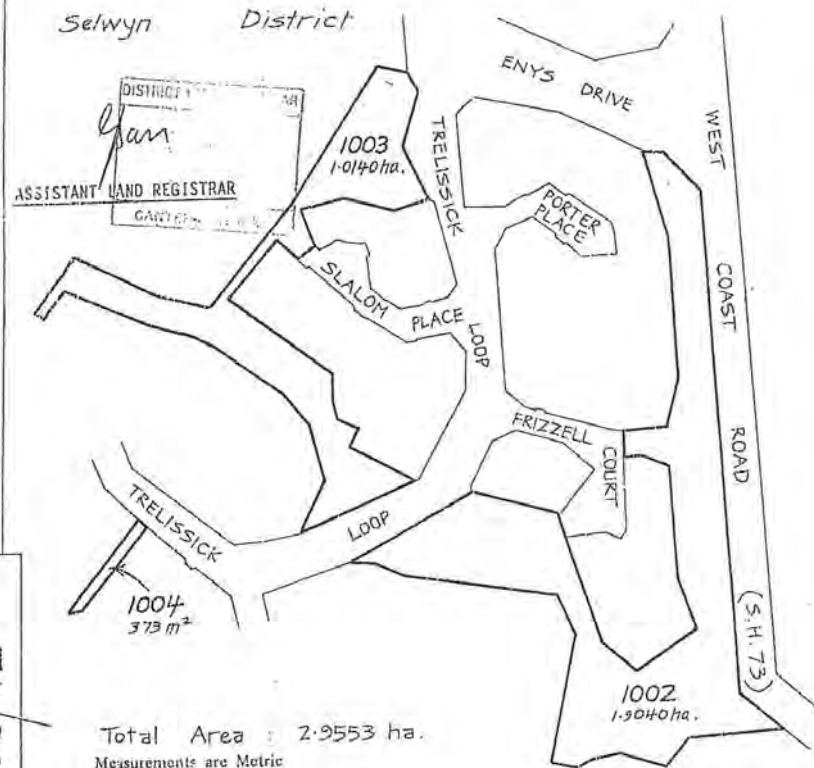

39C/12

MRB
11/9

Valuation Roll 2427/160 Pt

References
 Prior C/T 23A/343
 Transfer No.
 N/C. Order No. A130359/2

Land and Deeds 69



CERTIFICATE OF TITLE UNDER LAND TRANSFER ACT

This Certificate dated the 23rd day of August one thousand nine hundred and ninety-four under the seal of the District Land Registrar of the Land Registration District of CANTERBURY

WITNESSETH that THE SELWYN DISTRICT COUNCIL for Local Purpose (Utility) Reserve Subject to the Reserves Act 1977 ---

is seized of an estate in fee-simple (subject to such reservations, restrictions, encumbrances, liens, and interests as are notified by memorial underwritten or endorsed hereon) in the land hereinafter described, delineated with bold black lines on the plan hereon, be the several admeasurements a little more or less, that is to say: All that parcel of land containing 823 square metres or thereabouts being Lot 1005 Deposited Plan 45980 ---

DISTRICT OF Glan 1994
 ASSISTANT LAND REGISTRAR
 CANTONMENT N.Z.

Selwyn District

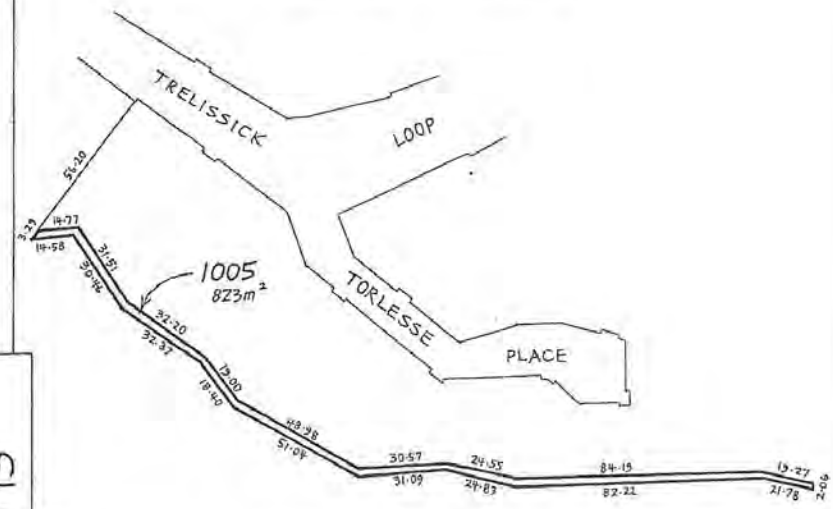

Measurements are Metric

No. 39C/13

No. 39C/13

MA

APPENDIX 2D: LINK STRIP RESERVES

Valuation Roll 2427/160 Pt

References
Prior C/T 23A/343
Transfer No.
N/C. Order No. A130359/3



Land and Deeds 59

CERTIFICATE OF TITLE UNDER LAND TRANSFER ACT

This Certificate dated the 23rd day of August one thousand nine hundred and ninety-four under the seal of the District Land Registrar of the Land Registration District of CANTERBURY
WITNESSETH that THE SELWYN DISTRICT COUNCIL for Local Purpose (Utility) Reserves Subject to the Reserves Act 1977 ---

is seized of an estate in fee-simple (subject to such reservations, restrictions, encumbrances, liens, and interests as are notified by memorial underwritten or endorsed hereon) in the land hereinafter described, delineated with bold black lines on the plan hereon, be the several admeasurements a little more or less, that is to say: All that parcel of land containing 24 square metres or thereabouts being Lots 1006, 1007, 1008, 1009, 1010, 1011, 1012, 1013, 1014, 1015, 1016, 1017, 1018, 1019, 1020, 1021, 1022, 1023, 1024 and 1025 Deposited Plan 45980 ---

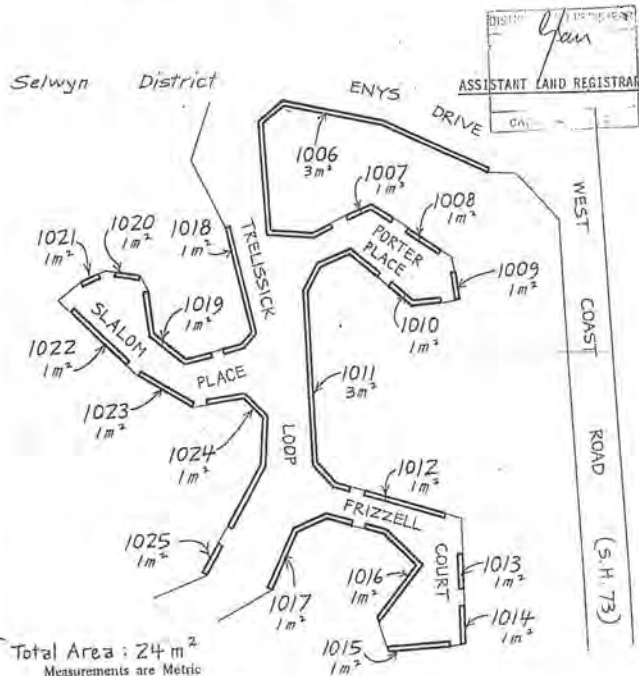

Total Area: 24 m²
Measurements are Metric
For dimensions see D.P. 45980

No. 39C/14

No. 39C/14

Valuation Roll 2427/160 Pt

References
Prior C/T 24F/1240
Transfer No.
N/C. Order No. A130359/4



Land and Deeds 59

CERTIFICATE OF TITLE UNDER LAND TRANSFER ACT

This Certificate dated the 23rd day of August one thousand nine hundred and ninety-four under the seal of the District Land Registrar of the Land Registration District of CANTERBURY
WITNESSETH that THE SELWYN DISTRICT COUNCIL for Local Purposes (Utility) Reserve Subject to the Reserves Act 1977 ---

is seized of an estate in fee-simple (subject to such reservations, restrictions, encumbrances, liens, and interests as are notified by memorial underwritten or endorsed hereon) in the land hereinafter described, delineated with bold black lines on the plan hereon, be the several admeasurements a little more or less, that is to say: All that parcel of land containing 7 square metres or thereabouts being Lots 1032, 1033, 1034, 1035, 1036, 1037 and 1038 Deposited Plan 45981 ---

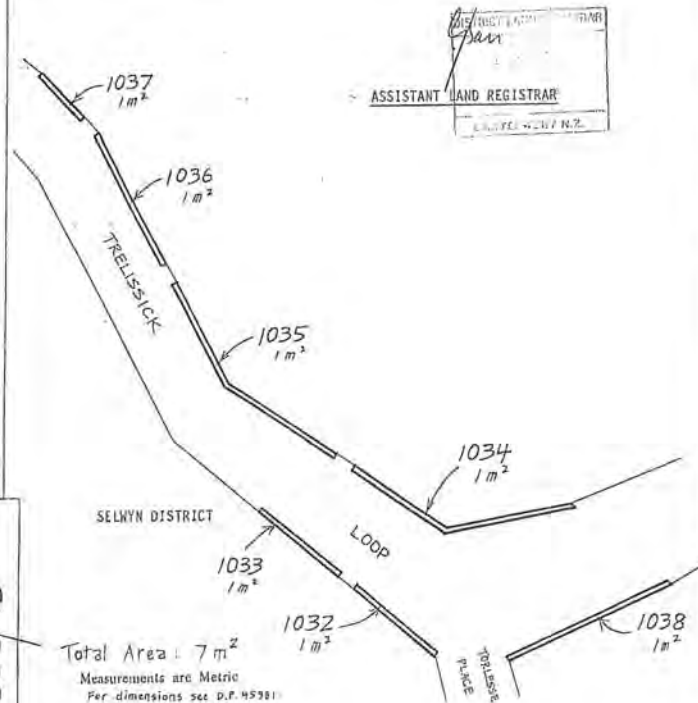

Total Area: 7 m²
Measurements are Metric
For dimensions see D.P. 45981

No. 39C/15

No. 39C/15

No. 39C / 56

References
Prior C/T 24F/1240

Transfer No.
N/C. Order No. A130362/3



CERTIFICATE OF TITLE UNDER LAND TRANSFER ACT

This Certificate dated the 23rd day of August one thousand nine hundred and ninety-four under the seal of the District Land Registrar of the Land Registration District of CANTERBURY

WITNESSETH that THE SELWYN DISTRICT COUNCIL for Local Purpose (Utility) Reserve Subject to the Reserves Act 1977 ---

In seized of an estate in fee-simple (subject to such reservations, restrictions, encumbrances, liens, and interests as are notified by memorial underwritten or endorsed hereon) in the land hereinafter described, delineated with bold black lines on the plan hereon, be the several admeasurements a little more or less, that is to say: All that parcel of land containing 7 square metres or thereabouts being lots 1026, 1027, 1028, 1029, 1030, 1031 and 1040 Deposited Plan 45983 ---

DISTRICT LAND REGISTRAR
[Signature]
ASSISTANT LAND REGISTRAR
[Signature]

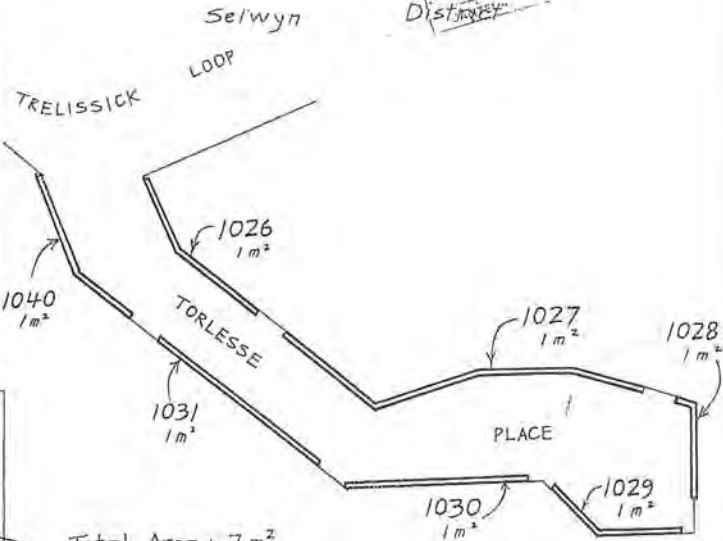

Total Area: 7 m²
Measurements are Metric
For dimensions see D.P. 45983

No. 39C / 56

APPENDIX 2E: 1995/2000 CAVEAT (RESERVES EXTENSION AREA 'A')

1:49 FAX 04 3 3243531 SELWYN DISTRICT DARFIELD SC 002/004

CAVEAT
 [Caveat forbidding registration of dealing with Estate or Interest]
 Land Transfer Act 1952



If there is not enough space in any of the panels below, cross-reference to and use the approved Annexure Schedule: no other format will be received.

Land Registration District
CANTERBURY

Certificate of Title No.	All or Part?	Area and legal description - Insert only when part or Stratum, CT
25A	1145	All

Caveator Names must be underlined or in CAPITALS
THE SELWYN DISTRICT COUNCIL

Estate or Interest claimed
 An interest as cestui que trust of a constructive trust arising out of a Deed dated 5 May 1995 made between the registered proprietor Castle Hill Resort Limited as Trustee and the Caveator under which Castle Hill Resort Limited promised to transfer that part of the land in Certificate of Title 24A/1145 more particularly shown marked "A" on the attached plan to the Caveator as a recreation reserve pursuant to the Reserves Act 1977.

Notice Clause
 Take notice that the above-named Caveator forbids the registration of any memorandum of transfer or other instrument affecting the said land until this caveat is withdrawn by me, or by order of the High Court, or until the same has lapsed under the provisions in that regard contained in Section 145 of the Land Transfer Act 1952.

Place where notices may be served
C/- Buddie Findlay, Solicitors, Level 13, Clarendon Tower, 78 Worcester Street, Christchurch

Address for service of Registered Proprietor
C/- O J Newbegin, Grassmere Lodge West Coast, Highway 73, Canterbury

Dated this 8 day of May 2000

Attestation

 Signature, or common seal of Caveator	Signed in my presence by the Caveator by its solicitor and duly authorized agent Denis Matthew SHEARD Signature of Witness
	Witness to complete in BLOCK letters below (unless typewritten or legibly stamped) Witness name: Jane Broomhead Occupation: Legal Executive to Buddie Findlay Address: Solicitors, Christchurch

Certified correct for the purposes of the Land Transfer Act 1952

 Solicitor for the Caveator

1:50 FAX 04 3 3243531 SELWYN DISTRICT DARFIELD SC 003/004

Approved by Registrar-General of Land under No. 1995/5003EF
Annexure Schedule



Caveat [] Dated [] Page 1 of 1 Pages



If this Annexure Schedule is used as an expansion of an instrument, all signing parties and either their witnesses or their solicitors must put their signatures or initials here.

Auckland District Law Society
 REF 4120

THIS DEED made this ^{DW} ^{May} 5th day of March 1995

BETWEEN CASTLE HILL RESORT LIMITED a duly incorporated Company having its registered office in Auckland ('the Company')

A N D SELWYN DISTRICT COUNCIL ('the Council')

WHEREAS:

- (a) The Company owns certain land comprising all the land situated in Certificate of Title 25A/1145 in the Canterbury Land Registry situated at Castle Hill intended for future residential subdivision.
- (b) The Company planned to vest an area of that land in the Council as Reserve Fund Contribution, for the purpose of adding to recreation reserves existing in the Village.
- (c) The Village community, including the Reserve Management Committee desires to have the use of that intended reserve for the purpose of proper development of recreational facilities in the community.
- (d) The Company is not yet in a position to proceed with the subdivision of the land, but is willing to vest land in the Council by way of Reserve Fund Contribution in advance, to enable the Reserve Management Committee to proceed with its development plans.

NOW THEREFORE IT IS AGREED AS FOLLOWS:

1. THE Company shall vest the land described in the plan attached to this agreement in the Council for use as recreational reserve.

2. THE Council accepts the vesting of that land from the Company on account of future Reserve Fund Contribution in respect of which the Company, or its assigns, may be liable to make in

Handwritten signatures